



Myrtle Close, Heeley, S2 3HW

Offers Over £240,000

3 2 1



Why We Love It

It's the location for us down the hill and you are in the heart of Sheffield City yet you are still close to green space so you really do have the best of both worlds in this beautiful well proportioned home.

Why You'll Love It

Enter the property via the hall with downstairs w.c, which is a perfect space for shoes and coats. To the left of the hall is the a spacious lounge with plenty of natural light and space for comfy seating. To the right of the hall is the fitted kitchen with space for a dining table perfect for socialising. Off the kitchen/diner are patio door straight out into the garden, a lovely aspect for summer evenings when entertaining guests. On the first floor is a master bedroom with en-suite, two further bedrooms, and a family bathroom. To the front of the property is a driveway that currently is housing the home office, to the rear a private garden with terrific views over the city of Sheffield. Myrtle Close is a stones throw away from the city centre, and is conveniently situated close to local amenities, great transport links, and close to good local schools. Likely to be of interest to a first time buyer, small family or an investor, this property has been kept to a great standard by its current owner.



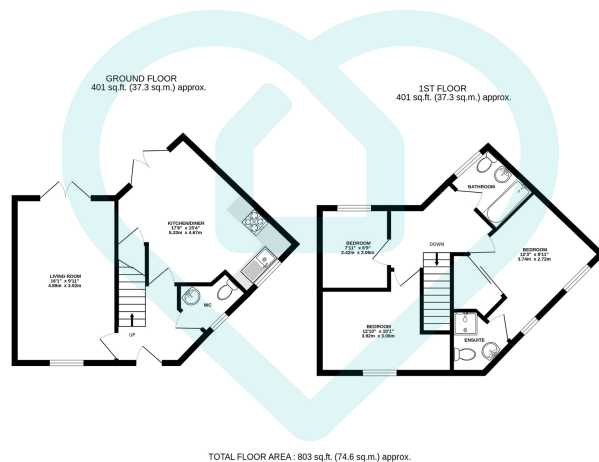

This floor plan is for illustrative purposes only. All measurements and layouts are approximations and do not necessarily capture the precise specifications of the property. No responsibility is taken for any error, omission, or misstatement. We always recommend viewing in person to confirm the exact floor plan of a property. Made with Metropix.



- Three Bedroom
- Semi-Detached Home
- Well Presented Throughout
- Perfect For First Time Buyers or Investors
- Great Transport Links
- Close To Sheffield City Centre
- Two Bathrooms
- Views Over The City
- Good Schools in Walking Distance
- Local Shops and Amenities

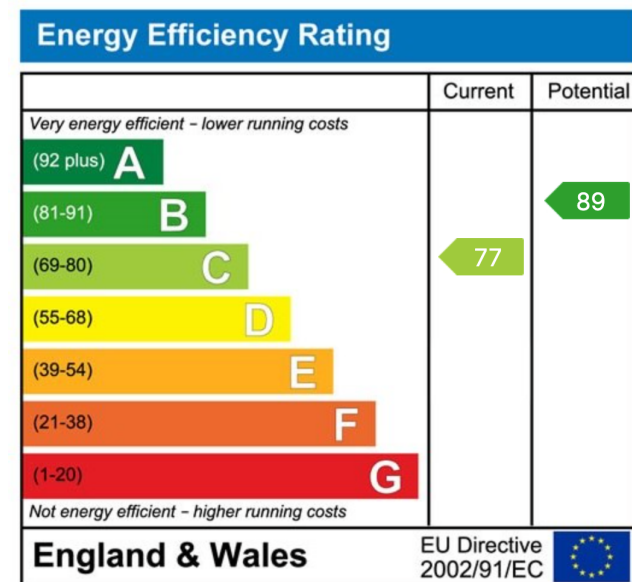

Sales | Lettings | New Homes

VAT Reg Number: 191 3588 84
Company Reg Number: 08610489
Company Reg Address: 67 Middlewood Road, Hillsborough, Sheffield, S6 4GX.

The MorfittSmith Building
67 Middlewood Road
Hillsborough
Sheffield
S6 4GX

Get in touch - arrange an appointment



0114 232 1764



sales@morfittsmith.co.uk
lettings@morfittsmith.co.uk
newhomes@morfittsmith.co.uk



www.morfittsmith.co.uk



@MorfittSmith



@MorfittSmith



MorfittSmith
Estate & Letting Agent